

# Site Plan (Key Utility Plan)

## What is a Site Plan?

A Site Plan, or sometimes referred to a Key Utility Plan, is a drawing of your site that shows existing and proposed buildings, structures, property lines and other features.

## Why do we need to see it?

The Site Plan is a critical drawing that we use to plan our site servicing and determine if there are potential conflicts, access issues or safety risks, so we can take these into account to ensure your project runs as smoothly as possible. This drawing is often used with Electrical Drawings to give us the best understanding of your site requirements.

### FILE FORMAT

**AutoCAD (.dwg)** in  
metric, with all  
drawings bound - no  
xrefs

**Adobe PDF (.pdf)**

## What does it need to show?

What we need to see	How much detail is required?	Why do we need to see it?
Property Lines	<ul style="list-style-type: none"><li>○ Show all the property lines surrounding and within the development site.</li></ul>	<ul style="list-style-type: none"><li>○ To determine the boundary of work, and if property rights are required.</li></ul>
Easements and/or Statutory Rights of Way	<ul style="list-style-type: none"><li>○ Show the location of any easements or statutory rights of way on the property.</li></ul>	<ul style="list-style-type: none"><li>○ To review any charges registered that may impact our ability to maintain and access our infrastructure.</li></ul>
Buildings	<ul style="list-style-type: none"><li>○ Show the footprint of any buildings on the site with distances to property lines.</li></ul>	<ul style="list-style-type: none"><li>○ To maintain minimum clearances in our design between our energized conductor and equipment and structures on your site.</li></ul>
Location of BC Hydro Equipment	<ul style="list-style-type: none"><li>○ Show applicable existing and proposed locations of any BC Hydro infrastructure.</li></ul>	<ul style="list-style-type: none"><li>○ To consider your proposed locations within our design, presuming it is accessible by our crews for the installation and operation of our equipment.</li></ul>
Service and Metering Locations	<ul style="list-style-type: none"><li>○ Show the location of any electrical room(s) and/or service entrance(s).</li><li>○ The location of any private pole(s) including the meter base location.</li></ul>	<ul style="list-style-type: none"><li>○ To review that the service location(s) meets BC Hydro requirements for access for our crews.</li></ul>
Other Utilities	<ul style="list-style-type: none"><li>○ Show the locations of existing or proposed utilities (waters, storm, sanitary, communications, etc.).</li></ul>	<ul style="list-style-type: none"><li>○ To coordinate required separations and clearances within our design.</li></ul>
Additional Site Information	<ul style="list-style-type: none"><li>○ Show parking spaces, curbs, driveways, sidewalks, environmental features, or other obstructions such as garbage bins, retaining walls, and snow pile areas.</li></ul>	<ul style="list-style-type: none"><li>○ To reduce the potential of conflicts in the access and operation of our infrastructure.</li></ul>

For more detailed information, please refer to our [Distribution Technical Standards and Guides](#) on bchydro.com

## SITE PLAN EXAMPLE – SIMPLE SINGLE LOT - DIGITIZED

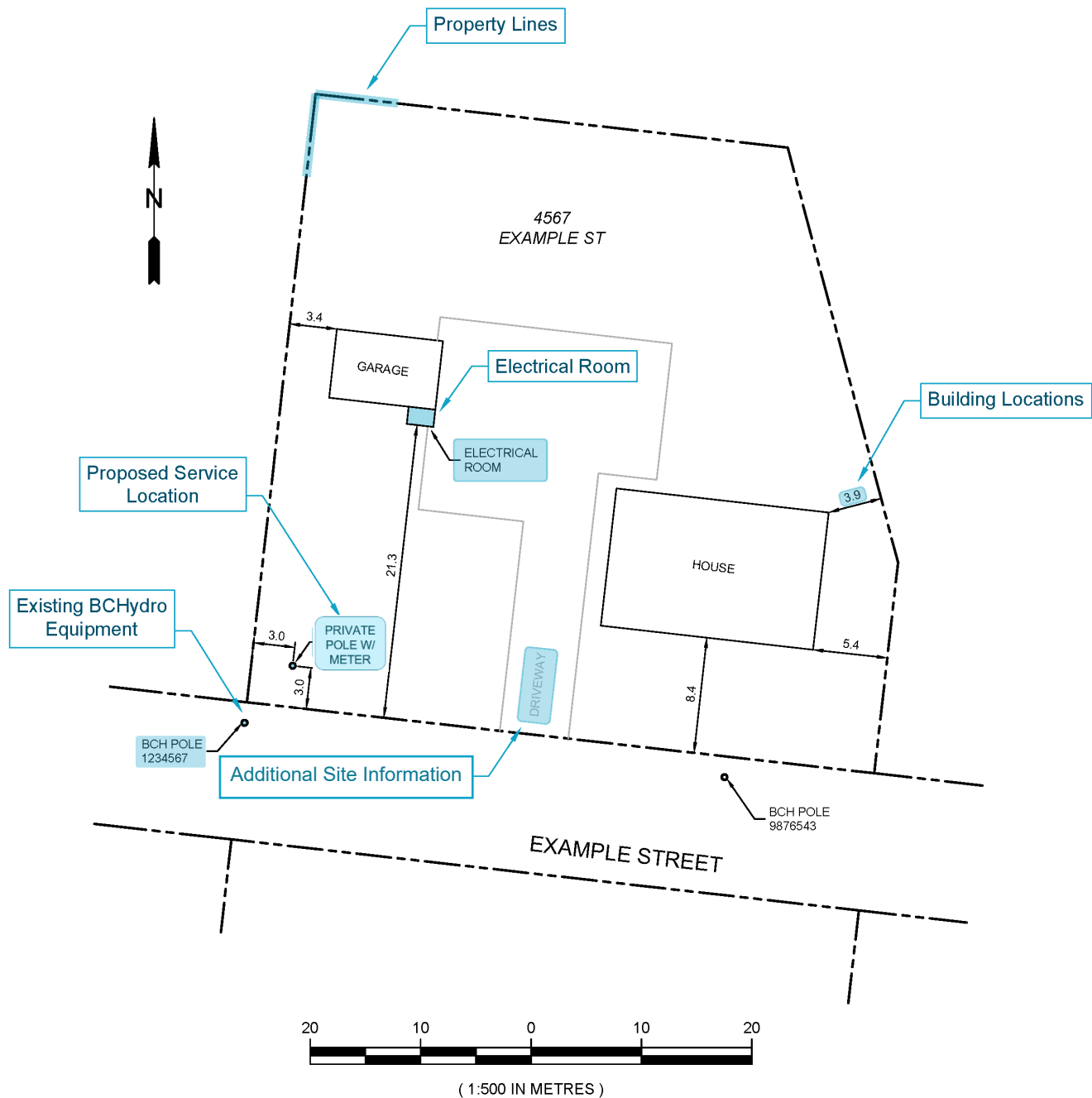

### Example of Required Information

The material and information shown in this document are intended for informational purposes only, and we'll be updating it from time to time. It has been created to emphasize common requirements, errors and omissions that can cause delays in the design process and may not reflect current industry and professional standards or requirements. It is not a substitute for legal, engineering or professional advice.

## SITE PLAN EXAMPLE – SIMPLE SINGLE LOT – HAND DRAWN

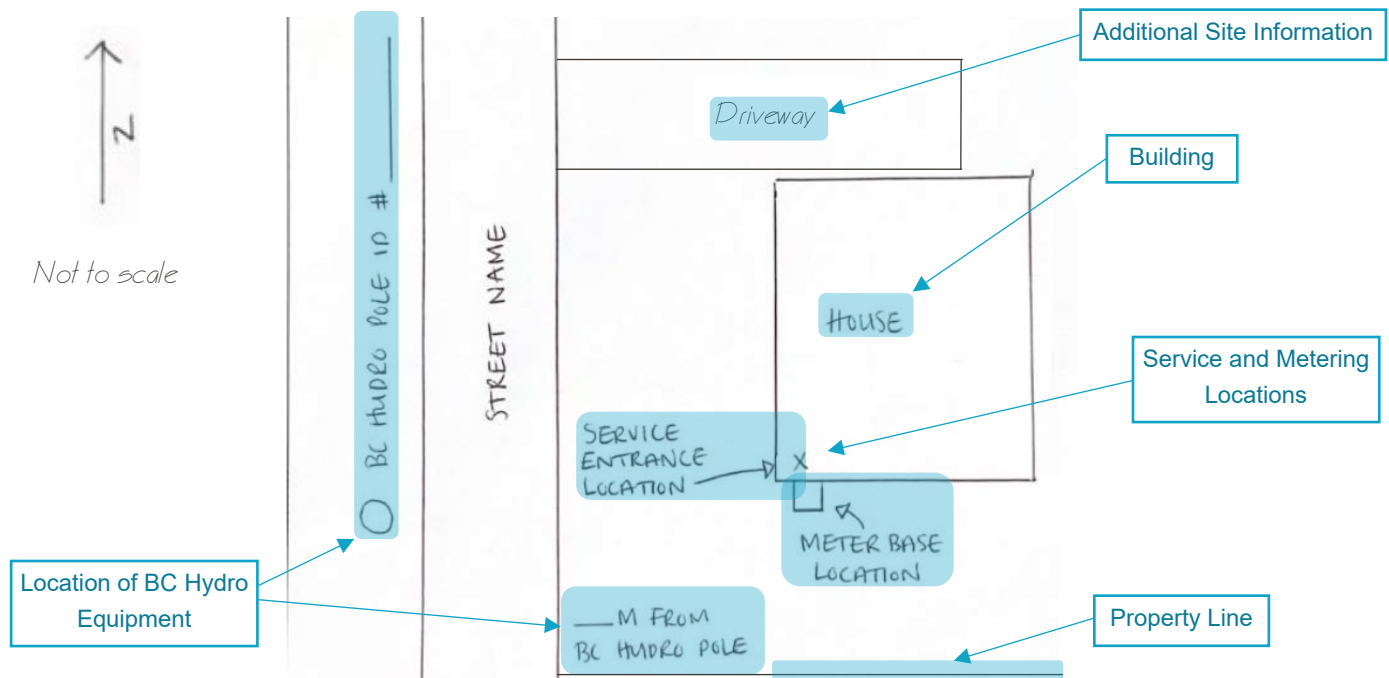

## SITE PLAN EXAMPLE – SIMPLE SINGLE LOT WITH CUSTOMER POLE – HAND DRAWN

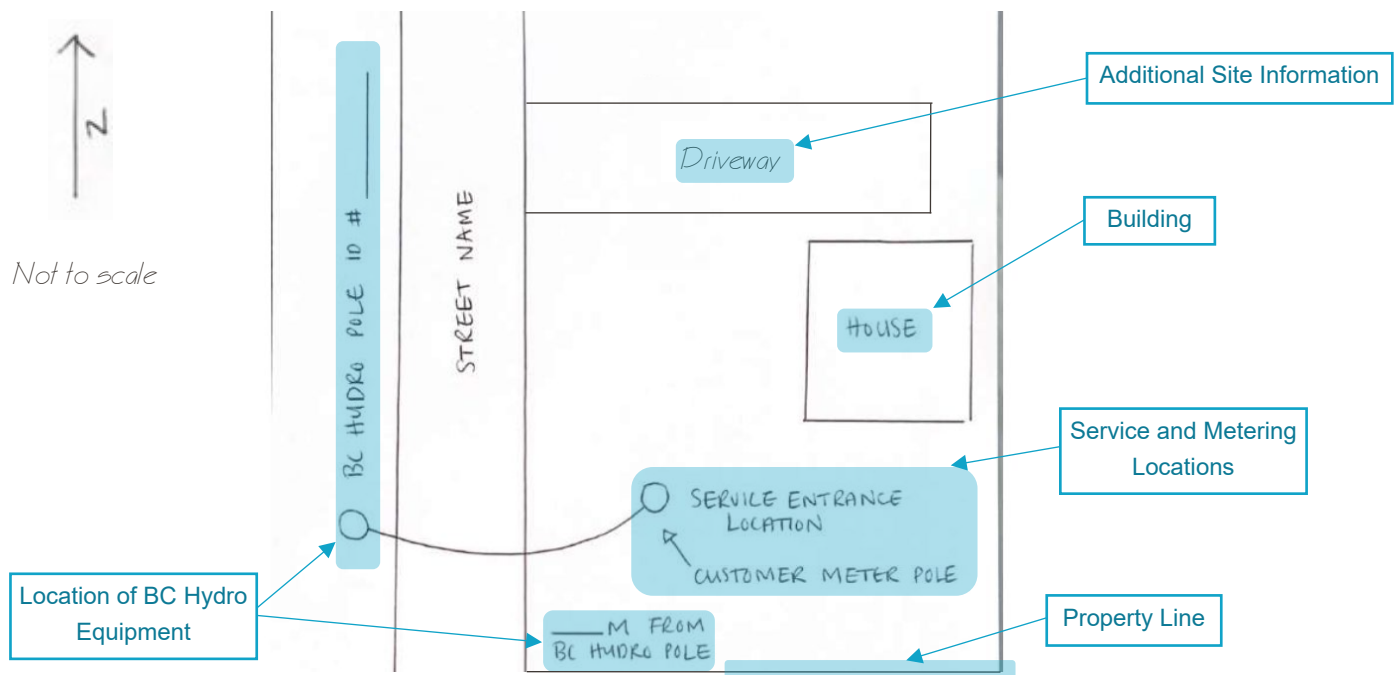

### Example of Required Information

The material and information shown in this document are intended for informational purposes only, and we'll be updating it from time to time. It has been created to emphasize common requirements, errors and omissions that can cause delays in the design process and may not reflect current industry and professional standards or requirements. It is not a substitute for legal, engineering or professional advice.

## SITE PLAN EXAMPLE - COMPLEX / MULTI-BUILDING

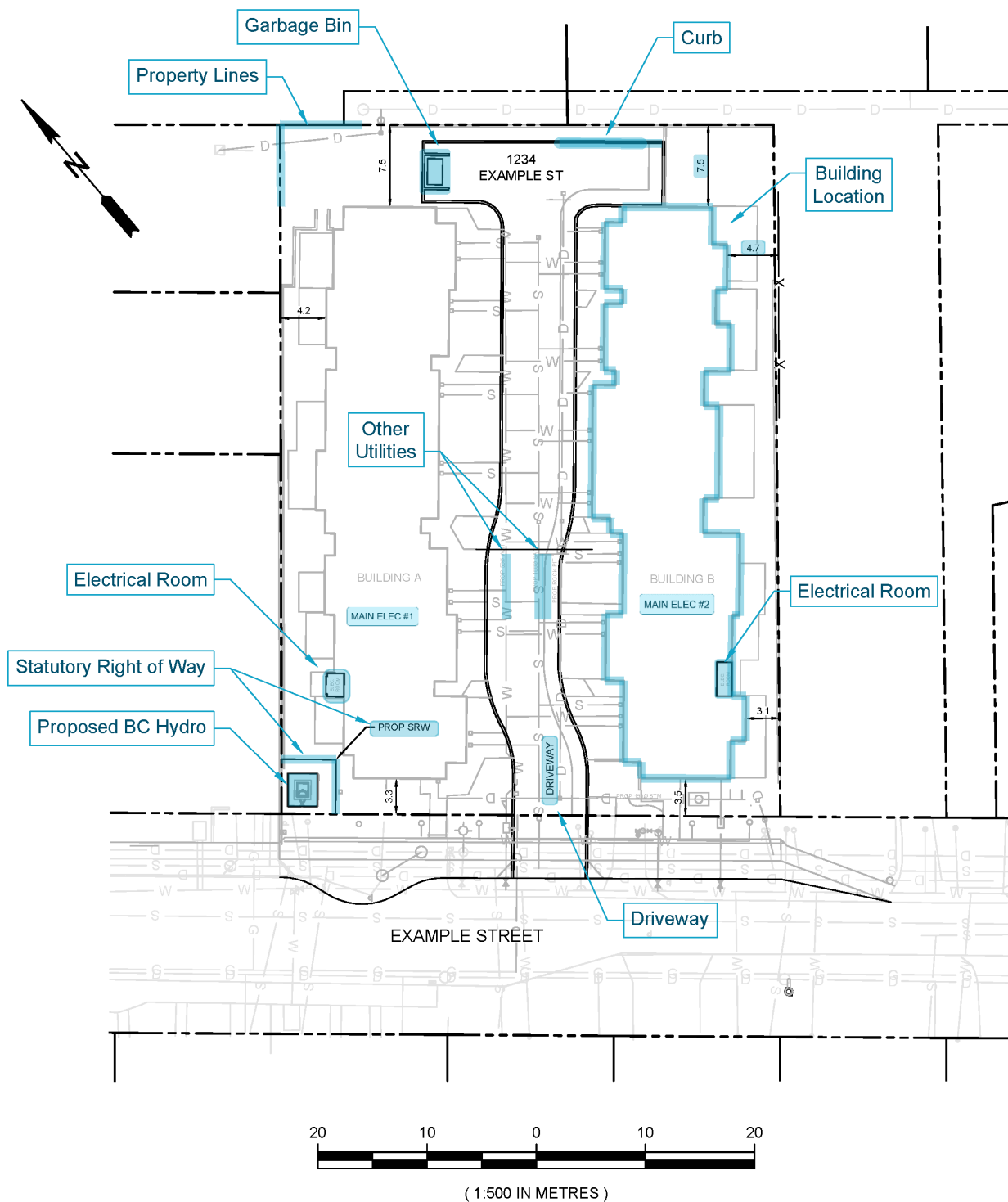

### Example of Required Information

The material and information shown in this document are intended for informational purposes only, and we'll be updating it from time to time. It has been created to emphasize common requirements, errors and omissions that can cause delays in the design process and may not reflect current industry and professional standards or requirements. It is not a substitute for legal, engineering or professional advice.